

**AIREN SHELA 24**

**Flats/Apartments for Sale**

**@ Opp.Shanti Business School, Shela,  
Ahmedabad**

**Manage By**



**Gujarat Rera Reg No. AG/GJ/AHMEDABAD/AHMEDABAD  
CITY/AUDA/AA00067/310822R1**

**Office Address: B-210, Titanium City Centre, 100  
Feet Rd, Near Sachin Tower, Satellite,  
Ahmedabad, Gujarat 380015**

**(M): 090672 31161**

**(E): [info@bquickproperty.com](mailto:info@bquickproperty.com)**

**(W): [www.bquickproperty.com](http://www.bquickproperty.com)**



**2 & 3 BHK**  
LIVING & SHOPS

AIRAN SHELA 24

AT SHELA

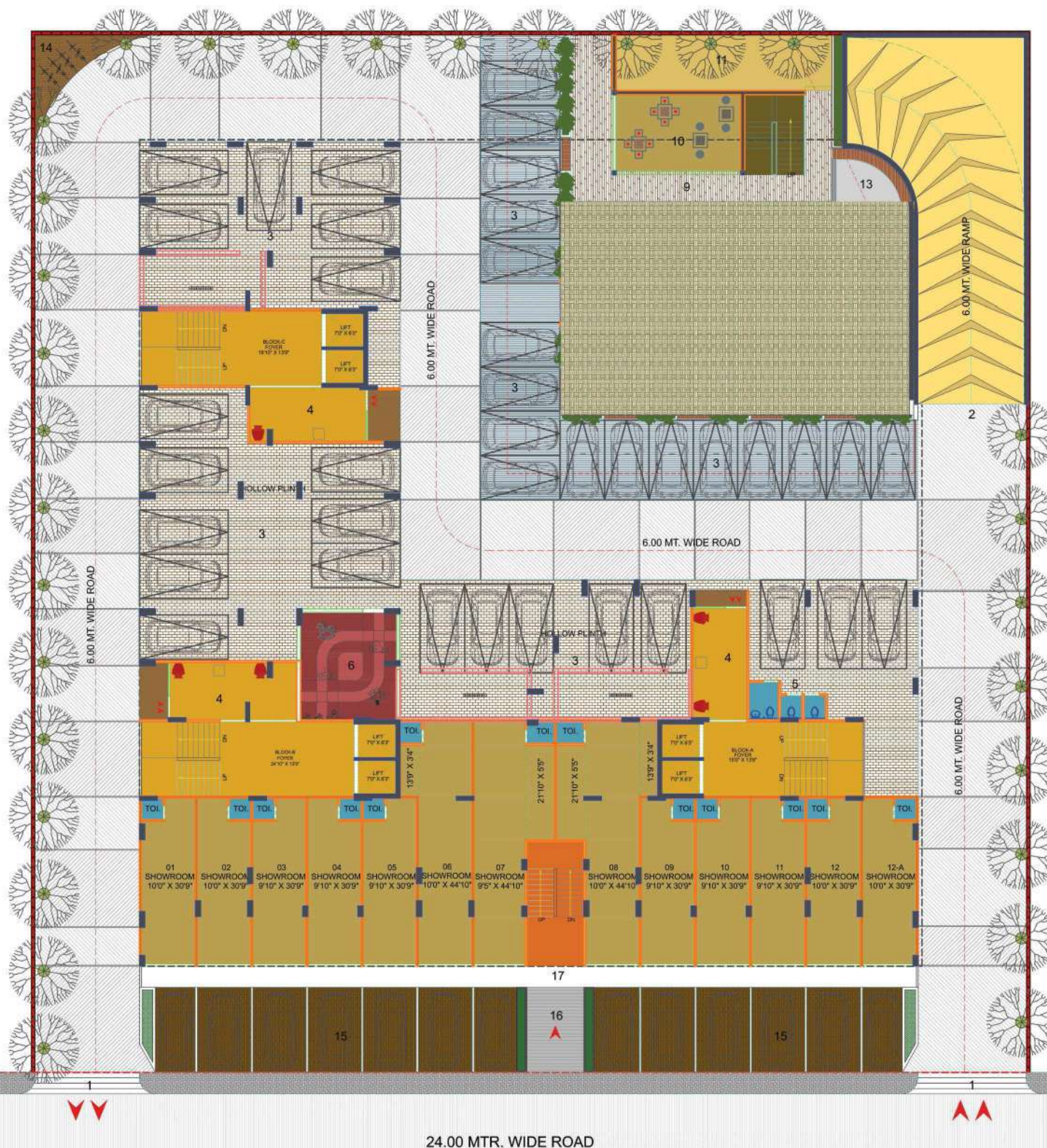

## GROUND FLOOR













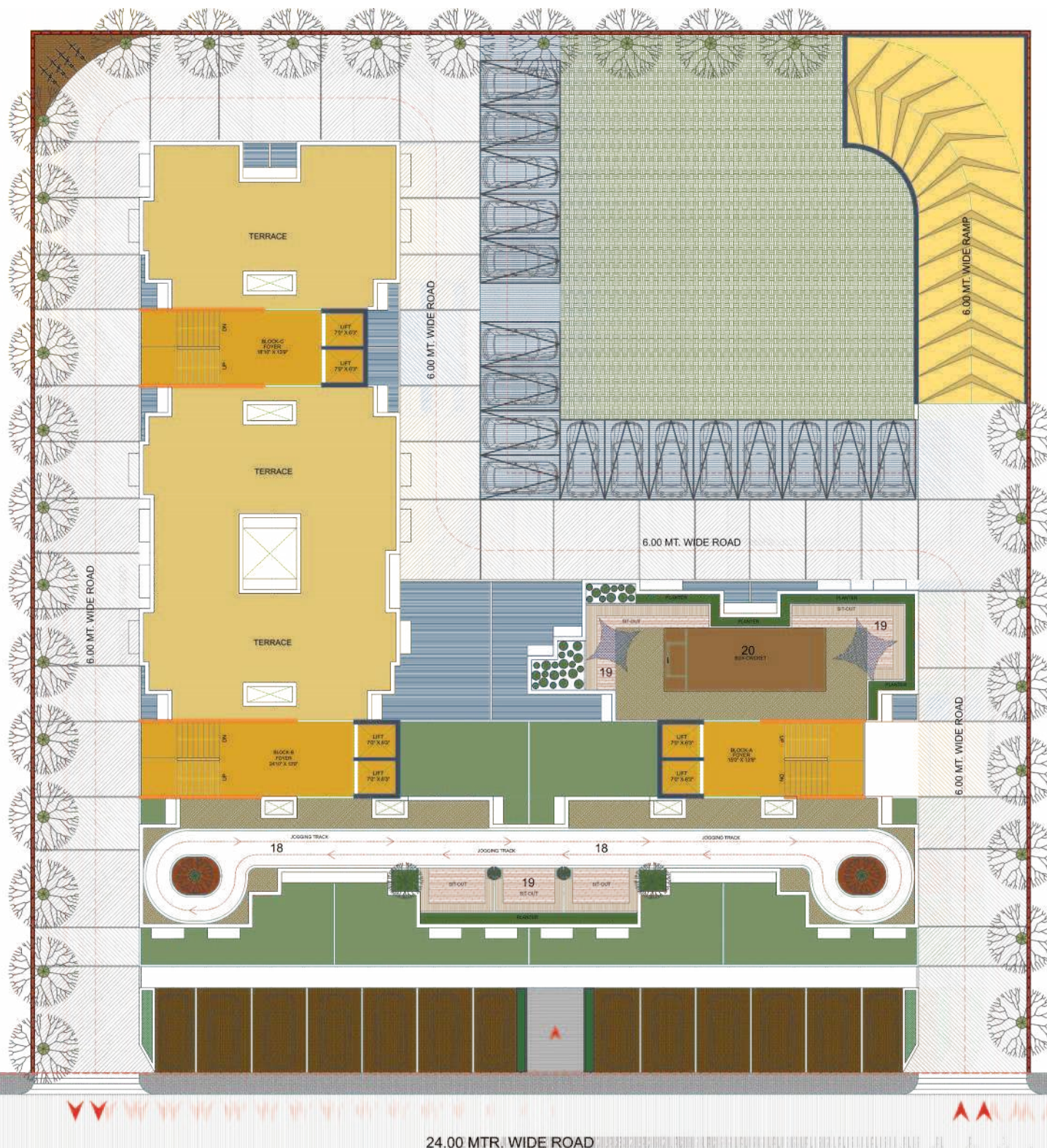

## TERRACE FLOOR





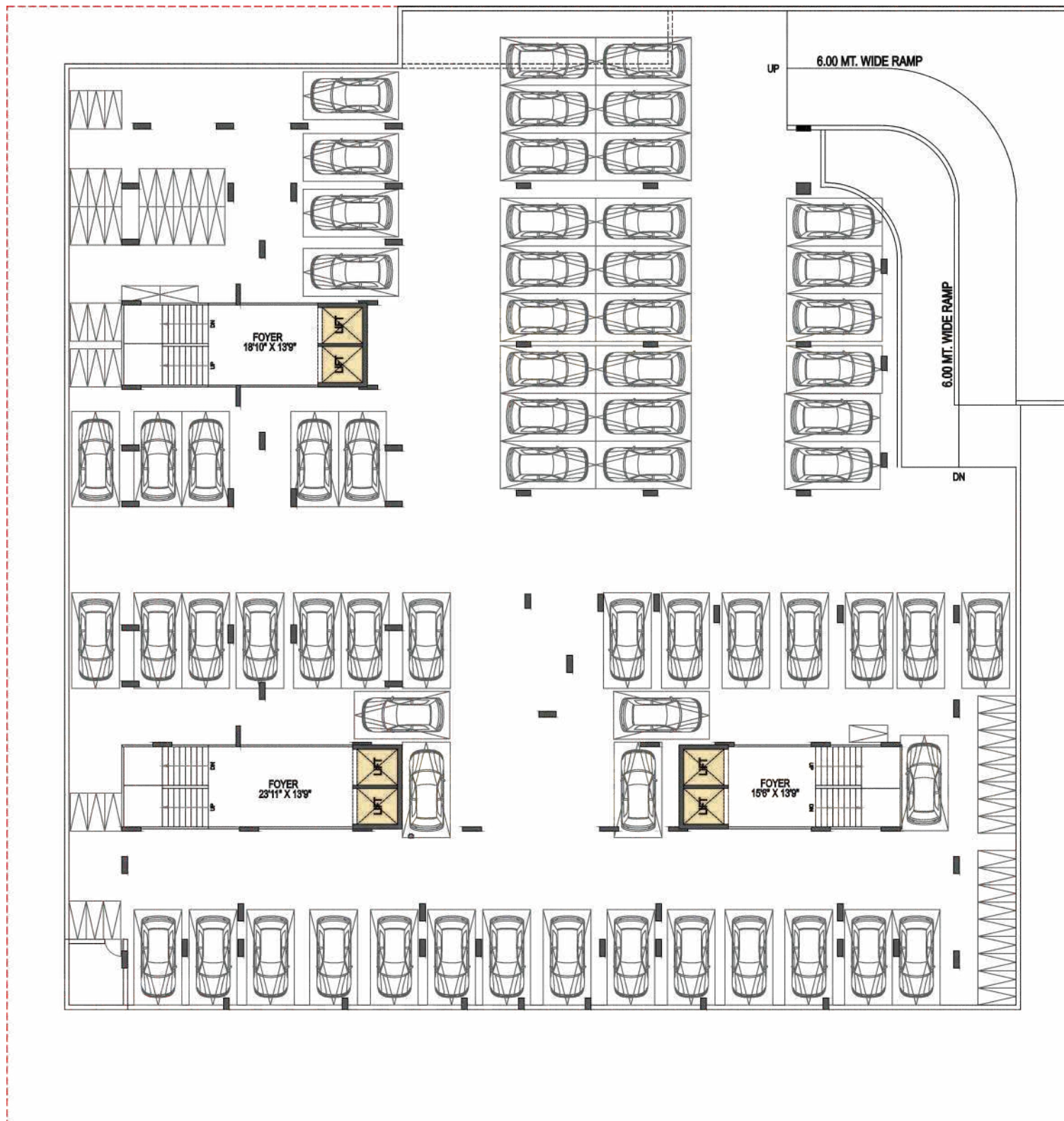

## BASEMENT 1 FLOOR





## BASEMENT 2 FLOOR





## 2 BHK - A UNIT PLAN





## 2 BHK - B UNIT PLAN





## 2 BHK - C UNIT PLAN





## 3 BHK UNIT PLAN







QR CODE

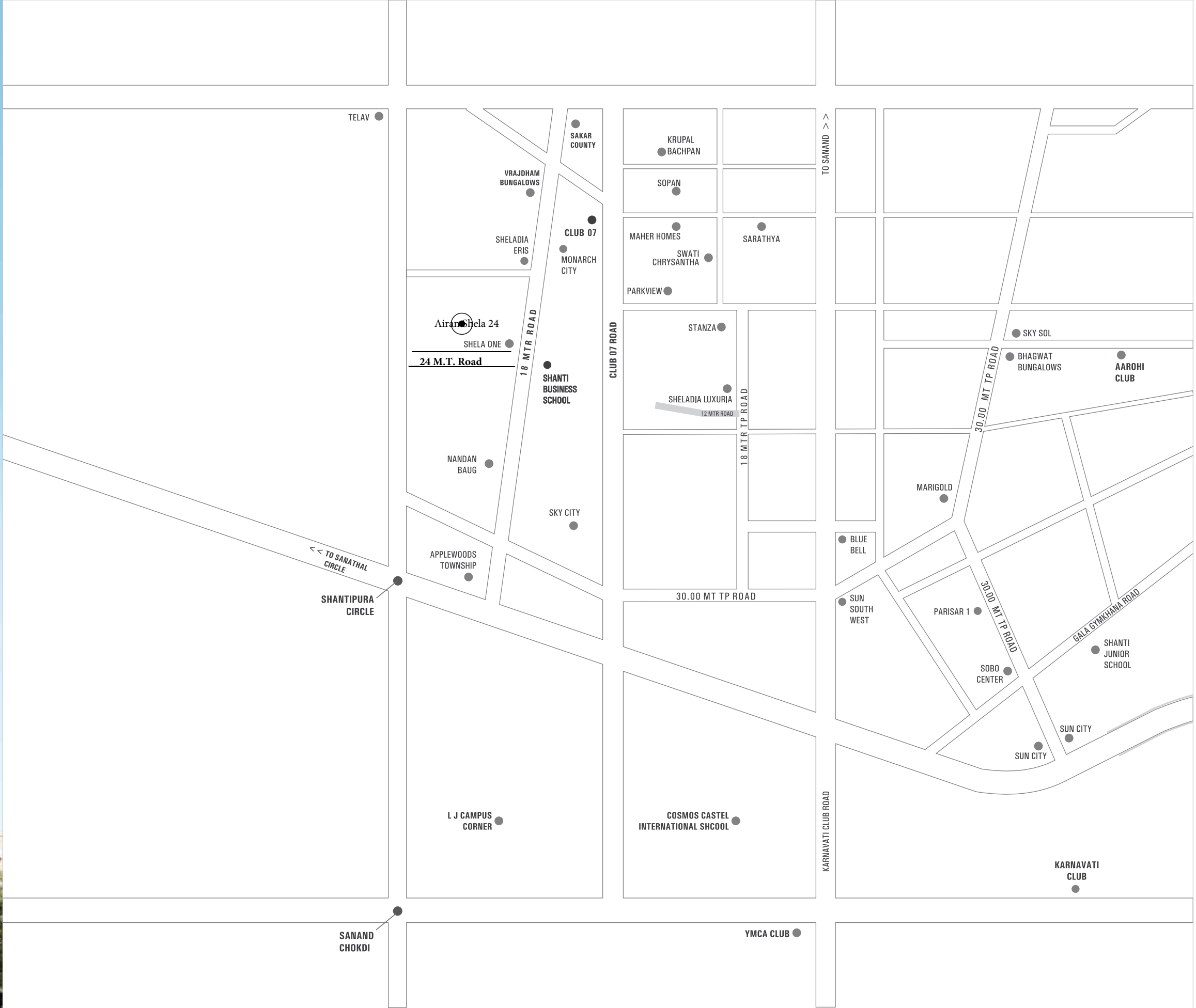

**RULES & REGULATIONS** • Stamp Duty, Registration Charges, Legal Documentation Charges, GST, Maintenance Deposit, Torrent Charges and any other charges shall be borne by buyer separately. • Any Additional charges of duties levied by government / Local authority during or after the completion of the project will be borne by the buyer. • Internal changes shall be done with prior permission and shall be charged in advance. • Changes in external elevation shall not be permitted. • All rights reserved by the developer for alteration / modification / improvement in specification / changes in dimensions and planning shall be binding to all. • Business practices leading to pollution, causing material damage to the building or members are not allowed in the premises. • Irregular payments may attract interest or lead to cancellation of bookings. **Parking shown in brochure is indicative and shall be provided as per plan to the society.**

**DISCLAIMER** • This brochure and model are not part of any legal documents. • All dimensions / measurement given are unfinished and approximates. • The photographs & artistic impressions are for references only. Actual building may vary from the representations mentioned in the brochure. • This is not an advertisement within the meaning of RERA. This is not an offer, invitation or commitment of any nature. Recipients are advised to appraise themselves of the necessary and relevant information of the project prior to making any purchase decisions. All the specifications of the flat shall be as per the final agreement between the parties. • Subject To Ahmedabad Jurisdiction • T&C Applicable"



# SPECIFICATION

## STRUCTURE

- RCC Structure designed with Earthquake resistant frame

## FLOORING

- Vitrified flooring in complete apartment
- Designer tiles in Bathrooms and Utility area
- Lobby with Vitrified tiles and Granite
- Lift Standard Company

## ELECTRIFICATION

- Modular switches
- ISI wires, MCB and ELCB

## KITCHEN

- Stainless steel sink (S.S. Sink)
- Dado tiles
- Granite Platform

## Doors & Windows

- Flus Doors with Both side laminate & quality lockers

## TOILETS/BATHROOMS

- Concealed Plumbing
- Health Faucet
- Wall design Glased / Ceramic Tiles up to Lintel Level
- Stone frames for Bathrooms
- CP Fittings: Jaguar, Cera or equivalent

## FIRE PREVENTIVE MEASURES

- Automatic fire sprinklers installed in the Hollow Plinth
- Manual panic alarm provided on each floor for fire safety