

Office Space for Sale
In Titanium Business Park
@ Off. S.G. Highway, Makarba, Ahmedabad

Manage By



**Gujarat Rera Reg No. AG/GJ/AHMEDABAD/AHMEDABAD
CITY/AUDA/AA00067/310822R1**

**Office Address: B-210, Titanium City Centre, 100
Feet Rd, Near Sachin Tower, Satellite,
Ahmedabad, Gujarat 380015**

(M): 090672 31161

(E): info@bquickproperty.com

(W): www.bquickproperty.com



A BENCHMARK
BUSINESS
ADDRESS

TITANIUM
BUSINESS PARK



WHEN YOU DESIRE NOTHING LESS THAN PERFECT.
WHEN YOU WANT NOTHING LESS THAN THE IMPECCABLE
WHEN YOU EXPECT NOTHING LESS THAN THE ABSOLUTE



TITANIUM

BUSINESS PARK

IS THE BEST CHOICE
FOR YOUR BUSINESS TO GROW

TITANIUM

BUSINESS PARK



ELEGANT
ELEVATION





TITANIUM

BUSINESS PARK

ABSOLUTE
AESTHETICS



GROUND FLOOR PLAN



BLOCK A

UNIT NO.	CARPET SQ.MT.	CARPET SQ.FT.
01	87.31	940
02	74.97	807
03	48.85	526
04	61.41	661
05	48.99	527

BLOCK B

UNIT NO.	CARPET SQ.MT.	CARPET SQ.FT.
01	30.60	329
02	61.41	661

BLOCK C

UNIT NO.	CARPET SQ.MT.	CARPET SQ.FT.
01	61.41	661
02	61.68	664
03	30.16	325
04	61.68	664

BLOCK D

UNIT NO.	CARPET SQ.MT.	CARPET SQ.FT.
01	61.41	661
02	92.60	997
03	61.68	664
04	61.41	661



TITANIUM BUSINESS PARK
IS THE PINNACLE OF WHAT
A BUSINESS ENVIRONMENT CAN BE!

NOTHING
LESS THAN
THE BEST!



TITANIUM
BUSINESS PARK

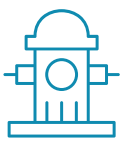

FIRE HYDRANT
SYSTEM



GYMNASIUM



LANDSCAPE
GARDEN



PLEASANT
SIT OUTS



PARKING
AREA



MULTI-PURPOSE
HALL



COMMON
TOILETS

BLOCK A
1ST TO 13TH FLOOR PLAN



UNIT NO.	CARPET SQ.MT.	CARPET SQ.FT.
01	30.07	324
02	28.14	303
03	30.35	327
04	29.89	322
05	29.89	322
06	29.89	322
07	29.89	322
08	29.89	322
09	29.89	322
10	29.89	322
11	29.89	322
12	29.41	317
13	43.64	470
14	41.69	449
15	30.07	324
16	32.79	353
17	32.79	353

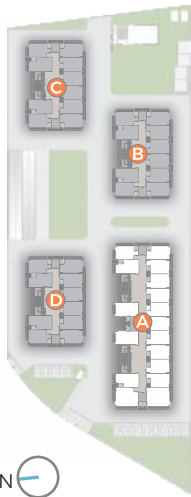

BLOCK B, C & D
BLOCK-B & C 1ST TO 12TH FLOOR PLAN
BLOCK-D 1ST TO 13TH FLOOR PLAN

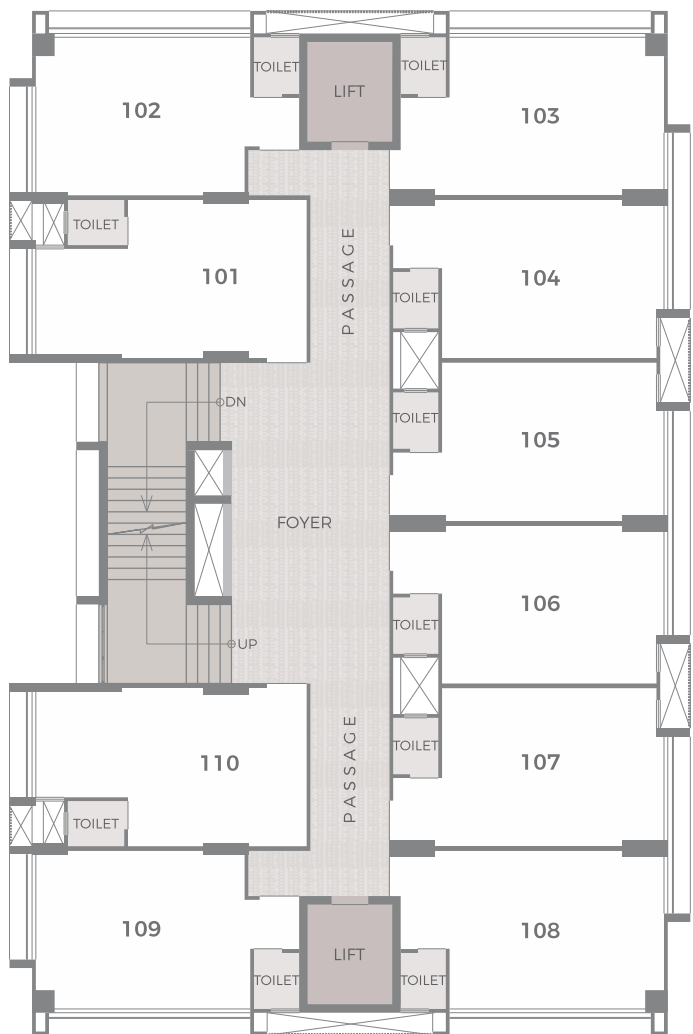

UNIT NO.	CARPET SQ.MT.	CARPET SQ.FT.
01	30.07	324
02	28.14	303
03	30.35	327
04	29.89	322
05	29.89	322
06	29.89	322
07	29.89	322
08	30.35	327
09	28.14	303
10	30.07	324

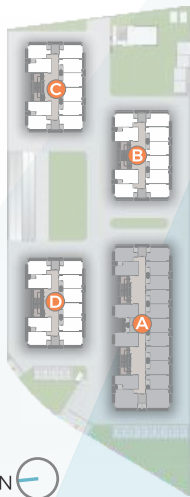

SPECIFICATIONS

FLOORING	VITRIFIED TILES 600MM X 600MM
DOOR	WOODEN FLUSH DOOR
INTERIOR PLASTER	SINGLE COAT MALA
EXTERIOR PLASTER	TEXTURE FINISH PLASTER
INSIDE FINISH	PUTTY FINISH
OUTSIDE PAINT	100% ACRYLIC PAINT
ELEVATORS	AUTOMATIC ELEVATORS WITH SPEED OF 1 METER PER SECOND
SANITARY WARE	WALL HUNG WATER CLOSET
	WALL HUNG BASIN
TOILET FITTINGS	CHROME PLATED FITTINGS
TOILET - FLOORING / DADO	CERAMIC TILES UPTO 4'0" FEET IN DADO
	CERAMIC TILES IN FLOORING
ELECTRIC SWITCHES	ISI MODULAR SWITCHES
ELECTRIC WIRES	ISI WIRES
MCB / ELCB	ISI MAKE

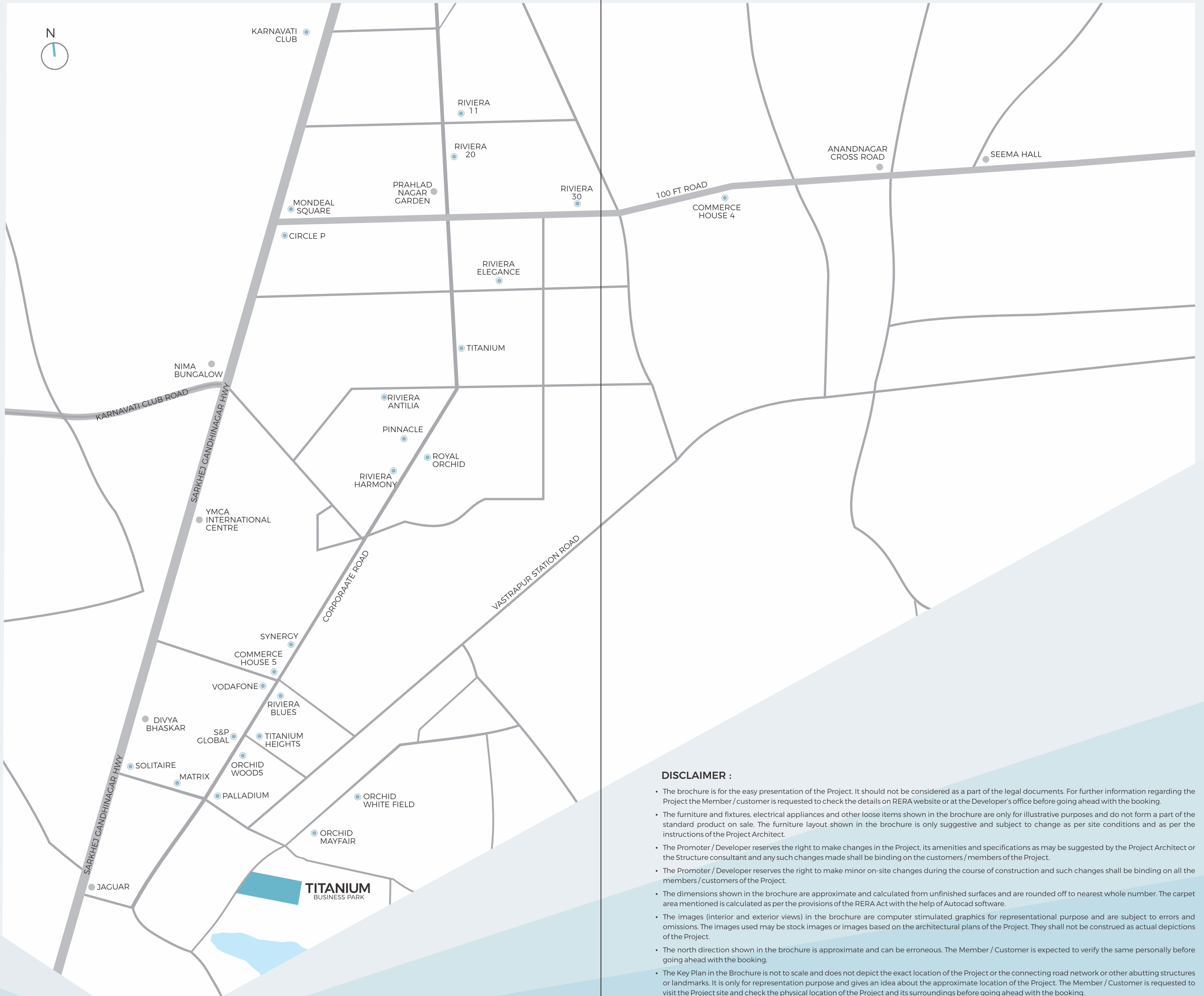

DISCLAIMER :

- The brochure is for the easy presentation of the Project. It should not be considered as a part of the legal documents. For further information regarding the Project the Member / customer is requested to check the details on RERA website or at the Developer's office before going ahead with the booking.
- The furniture and fixtures, electrical appliances and other loose items shown in the brochure are only for illustrative purposes and do not form a part of the standard product on sale. The furniture layout shown in the brochure is only suggestive and subject to change as per site conditions and as per the instructions of the Project Architect.
- The Promoter / Developer reserves the right to make changes in the Project, its amenities and specifications as may be suggested by the Project Architect or the Structure consultant and any such changes made shall be binding on the customers / members of the Project.
- The Promoter / Developer reserves the right to make minor on-site changes during the course of construction and such changes shall be binding on all the members / customers of the Project.
- The dimensions shown in the brochure are approximate and calculated from unfinished surfaces and are rounded off to nearest whole number. The carpet area mentioned is calculated as per the provisions of the RERA Act with the help of Autocad software.
- The images (interior and exterior views) in the brochure are computer stimulated graphics for representational purpose and are subject to errors and omissions. The images used may be stock images or images based on the architectural plans of the Project. They shall not be construed as actual depictions of the Project.
- The north direction shown in the brochure is approximate and can be erroneous. The Member / Customer is expected to verify the same personally before going ahead with the booking.
- The Key Plan in the Brochure is not to scale and does not depict the exact location of the Project or the connecting road network or other abutting structures or landmarks. It is only for representation purpose and gives an idea about the approximate location of the Project. The Member / Customer is requested to visit the Project site and check the physical location of the Project and its surroundings before going ahead with the booking.